

**SURFACE MOUNT POWER
INDUCTOR SERIES LPPI6028**

FEATURES

- Low profile
- High reliability and efficiency
- RoHS compliant plus Lead & Halogen free
- Magnetically shielded

ELECTRICAL SPECIFICATIONS

- Inductance range 1.0uH to 100.0uH
- Test frequency 100KHz with test level 1 V
- Test equipment Quadtech 1910 L analyzer
- Rated current range 0.72 to 5.75 Amps
- Tolerance ± 20% (M) & ± 30% (Y)
- Rated current Refer to notes below

PHYSICAL SPECIFICATIONS

- Operating temp. -40°C to +125°C
- Core Ferrite core
- Terminal construction Ag/Ni/Sn plating +
Lead free solder
- Packaging T & R 1500 pieces per reel
- Tape & reel spec. Tape 16 mm embossed carrier
Reel 330 mm reel

SPECIFICATIONS

Part Number	L (μ H)	Tol % ±	DCR ±20% (m Ω)	Rated Current (A)	
				I _{rms} ⁽¹⁾	I _{sat} ⁽²⁾
LPPI6028-1R0Y	1.00	30	10.0	5.20	5.75
LPPI6028-1R5Y	1.50	30	14.0	4.95	5.30
LPPI6028-2R2M	2.20	20	18.0	4.50	5.00
LPPI6028-3R3M	3.30	20	24.0	3.60	4.30
LPPI6028-4R7M	4.70	20	30.0	3.10	3.20
LPPI6028-6R8M	6.80	20	47.0	2.50	2.85
LPPI6028-100M	10.0	20	65.0	2.00	2.10
LPPI6028-150M	15.0	20	98.0	1.80	2.00
LPPI6028-220M	22.0	20	138.0	1.50	1.60
LPPI6028-330M	33.0	20	200.0	1.30	1.40
LPPI6028-470M	47.0	20	280.0	1.06	1.15
LPPI6028-680M	68.0	20	420.0	0.81	1.00
LPPI6028-101M	100.0	20	605.0	0.72	0.80

DIMENSIONS IN MILLIMETERS

- Length A 6.0 ± 0.2
- Width B 6.0 ± 0.2
- Height C 2.6 ± 0.2
- Terminal width D 1.6 ± 0.3
- Terminal length E 5.8 ± 0.3
- Terminal center space F 4.3 ref.

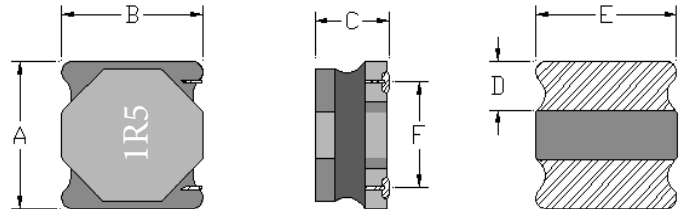

RECOMMENDED PC BOARD PATTERN

- L = 6.1 mm ref.
- G = 2.5 mm ref.
- H = 5.8 mm ref.

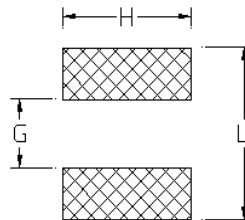

Notes:

- (1) Based on coil temperature rise ΔT approximately 40°C
- (2) L drops 30% from OCL typical

All test data based on 25°C ambient
Part temperature (ambient + temperature rise) must not exceed 125°C under worst case operating conditions.
Circuit design, components, PCB trace size, airflow and other cooling provisions all effect the part temperature.