

**SURFACE MOUNT POWER
INDUCTOR SERIES LPPI4018**

FEATURES

- Low profile
- High reliability and efficiency
- RoHS compliant plus Lead & Halogen free
- Magnetically shielded

ELECTRICAL SPECIFICATIONS

- Inductance range 1.0uH to 220.0uH
- Test frequency 100kHz with test level 1 V
- Test equipment Quadtech 1910 L analyzer
- Rated current range 0.25 to 3.60 Amps
- Tolerance ± 20% (M) & ± 30% (Y)
- Rated current Refer to notes below

PHYSICAL SPECIFICATIONS

- Operating temp. -40°C to +125°C
- Core Ferrite core
- Terminal construction Ag/Ni/Sn plating
- Packaging T & R 3500 pieces per reel
- Tape & reel spec. Tape 12 mm embossed carrier
- Reel 330 mm reel

SPECIFICATIONS

Part Number	L (μH)	Tol % ±	DCR ±20% (mΩ)	Rated Current (A)	
				I _{rms} ⁽¹⁾	I _{sat} ⁽²⁾
LPPI4018-1R0Y	1.0	30	27	3.60	3.60
LPPI4018-1R5Y	1.5	30	32	3.00	3.00
LPPI4018-2R2M	2.2	20	42	2.70	2.70
LPPI4018-3R3M	3.3	20	55	2.20	2.20
LPPI4018-4R7M	4.7	20	70	1.90	1.90
LPPI4018-6R8M	6.8	20	98	1.60	1.60
LPPI4018-100M	10.0	20	150	1.40	1.40
LPPI4018-150M	15.0	20	190	1.00	1.00
LPPI4018-220M	22.0	20	290	0.80	0.80
LPPI4018-330M	33.0	20	405	0.70	0.70
LPPI4018-470M	47.0	20	550	0.55	0.55
LPPI4018-680M	68.0	20	890	0.50	0.50
LPPI4018-101M	100.0	20	1380	0.40	0.40
LPPI4018-151M	150.0	20	1970	0.30	0.30
LPPI4018-221M	220.0	20	3000	0.25	0.25

DIMENSIONS IN MILLIMETERS

- Length A 4.0 ± 0.2
- Width B 4.0 ± 0.2
- Height C 1.8 max.
- Terminal width D 1.2 ref.
- Terminal pitch E 1.6 ref.

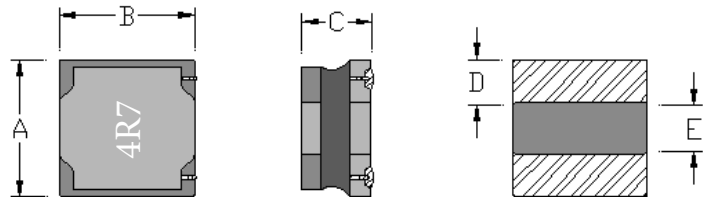

RECOMMENDED PC BOARD PATTERN

- L = 4.2 mm ref.
- G = 1.4 mm ref.
- H = 4.2 mm ref.

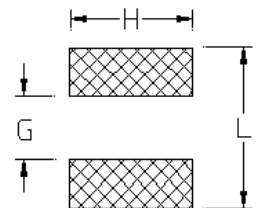

Notes:

- (1) Based on coil temperature rise ΔT approximately 40°C
- (2) L drops 30% from OCL typical

All test data based on 25°C ambient
 Part temperature (ambient + temperature rise) must not exceed 125°C under worst case operating conditions.
 Circuit design, components, PCB trace size, airflow and other cooling provisions all effect the part temperature.