

**SURFACE MOUNT POWER
INDUCTOR SERIES LPPI3010**

FEATURES

- Low profile
- High reliability and efficiency
- RoHS compliant plus Lead & Halogen free
- Magnetically shielded

ELECTRICAL SPECIFICATIONS

- Inductance range 1.0uH to 22.0uH
- Test frequency 1MHz with test level 0.1 V
- Test equipment Quadtech 1910 L analyzer
- Rated current range 0.43 to 2.1 Amps
- Tolerance ± 20% (M) & ± 30% (Y)
- Rated current Refer to notes below

PHYSICAL SPECIFICATIONS

- Operating temp. -40°C to +125°C
- Core Ferrite core
- Terminal construction Ag/Ni/Sn plating
- Packaging T & R 2000 pieces per reel
- Tape & reel spec. Tape 8 mm embossed carrier
Reel 178 mm reel

SPECIFICATIONS

Part Number	L (μH)	Tol % ±	DCR ±20% (mΩ)	Rated Current (A)	
				I _{rms} ⁽¹⁾	I _{sat} ⁽²⁾
LPPI3010-1R0Y	1.0	30	55.0	2.10	1.80
LPPI3010-1R5Y	1.5	30	70.0	1.90	1.50
LPPI3010-2R2M	2.2	20	90.0	1.70	1.30
LPPI3010-3R3M	3.3	20	130.0	1.50	1.10
LPPI3010-4R7M	4.7	20	170.0	1.30	0.90
LPPI3010-6R8M	6.8	20	260.0	1.00	0.77
LPPI3010-100M	10.0	20	350.0	0.80	0.63
LPPI3010-150M	15.0	20	510.0	0.70	0.54
LPPI3010-220M	22.0	20	750.0	0.60	0.43

DIMENSIONS IN MILLIMETERS

- Length A 3.0 ± 0.2
- Width B 3.0 ± 0.2
- Height C 1.0 max.
- Terminal width D 1.0 ref.
- Terminal pitch E 1.0 ref.

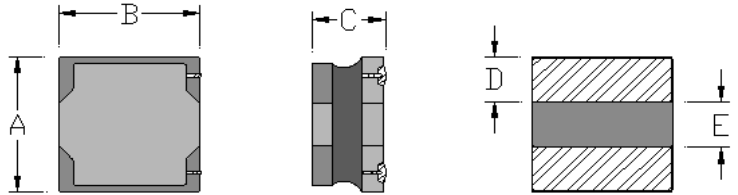

RECOMMENDED PC BOARD PATTERN

- L = 3.2 mm ref.
- G = 1.0 mm ref.
- H = 3.2 mm ref.

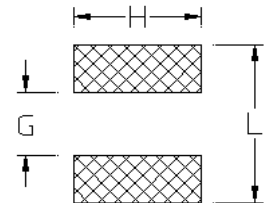

Notes:

- (1) Based on coil temperature rise ΔT approximately 40°C
- (2) L drops 30% from OCL typical

All test data based on 25°C ambient
 Part temperature (ambient + temperature rise) must not exceed 125°C under worst case operating conditions.
 Circuit design, components, PCB trace size, airflow and other cooling provisions all effect the part temperature.